

OPERATING INSTRUCTIONS RH-60

- Use only non-foaming, non-chlorinated detergents suitable for automatic dishwashers such as Rhima's range of detergents.
- Ensure clear hose is inserted into the detergent bottle and green hose is inserted into rinse additive bottle.
- For best performance connect machine to HOT water.
- If pre-soaking do not use regular dishwashing liquid as significant foaming may result during the wash cycle.

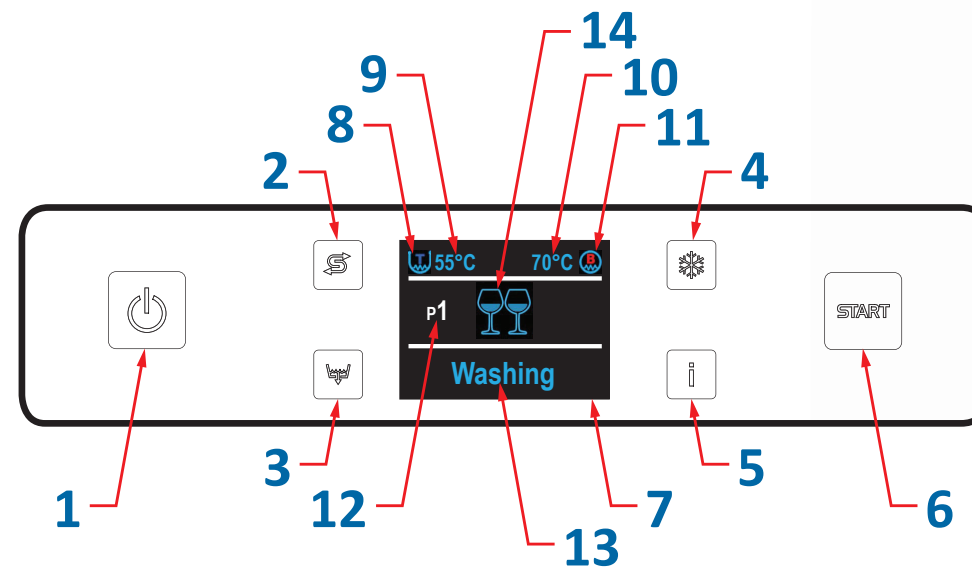

- (1) Power ON or STAND-BY
- (2) Regeneration (Optional - Not supplied)
- (3) Drain button
- (4) Extra cold rinse (Optional - Not supplied)
- (5) Information
- (6) START - to start and cycle selection
- (7) Display
- (8) Tank status - If T is red the heating element is on
- (9) Tank temperature
- (10) Boiler temperature
- (11) Boiler status - If B is red the heating element is on
- (12) Cycle code
- (13) Cycle Name
- (14) Cycle Icon

Operating the machine

INITIAL FILL AND HEATING

1. Close the hood and press the ON/STAND-BY switch (1). The machine's display (7) will show [down arrow] and the date/time at the top of the screen.
2. Press the ON/STAND-BY button (1) and it will turn from red to green. On the display (13) the message FILLING WATER and then HEATING will occur.
The heating will remain until the wash-tank T (9) and boiler B (10) have reached their set temperatures. During this process the machine will not allow any cycle selection to start.
3. The machine is ready for use once the display (7) shows the last cycle carried out before previously switching off the machine.

DISHWASHER OPERATION

1. Place items on the supplied racks ensuring the plates, cups, and glasses do not overlap. Cutlery to be placed in the cutlery cylinder.
2. Select the required cycle by pushing the green START button (6). The display will show in sequence all these available cycles (12) and (13). Once the required cycle is displayed release the button. Press the START button (6) to begin the cycle.
3. During the cycle the display will read the wash tank temperature (9) and the boiler temperature (10) located at the top of the display (7). The display (13) will change from WASHING to TANK DRAINING to RINSING to CYCLE ENDED with the count up percentage of progression for the cycle (14).
4. At the end of the cycle a hot rinse cycle will take place. The START button (6) will flash blue/green to indicate the CYCLE ENDED (13).
5. The washed items will air-dry within minutes of the hood being opened on the washer. The use of rinse additive will improve drying times.

Draining the machine

1. To maintain good wash results, the dishwasher should be drained and refilled every 2-4 hours depending on frequency of use and level of soil/residue on items being washed.
2. With the machine ON, press the Drain button (3) for 4 seconds. The display will show TANK DRAINING (13).
3. Once tank is drained remove the SURFACE FILTERS (A) and PUMP FILTER (B) and clean them under running water. Replace the SURFACE FILTERS (A) and the PUMP FILTER (B) after cleaning and before initiating a new cycle, Fig. 1.

WHEN REMOVING THE SURFACE FILTERS (A) AND PUMP FILTER (B) CAREFULLY MAKE SURE SCRAPS OF FOOD DO NOT FALL INTO THE DRAIN PUMP.

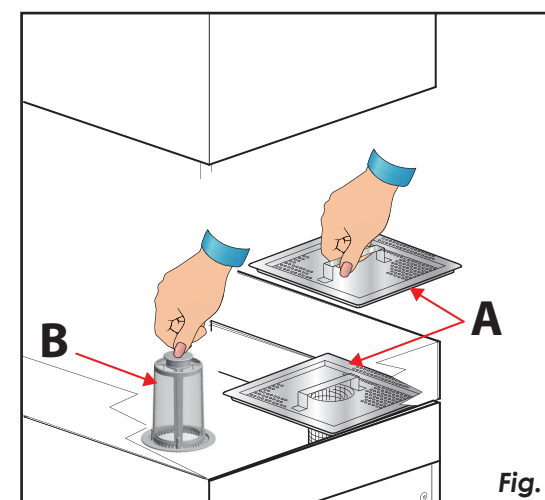

4. At the end of the day, the dishwasher should be drained, switched off and the hood left open to ventilate.

Self Clean Cycle & Regular Maintenance

SELF CLEAN CYCLE

1. The machine's SELF-CLEANING/RINSING cycle is recommended at the end of each day while the SURFACE FILTERS (A) and PUMP FILTER (B) are removed.
2. The machine should be in STAND-BY mode when you push the START button (6) for 4 seconds. An automatic cycle of 60 seconds will start and will end up back in STAND-BY mode.
3. On completion, drain the machine by following machine draining instructions.

REGULAR MAINTENANCE

1. When the tank is drained, remove the wash/rinse arms by loosening the fixing screws (C) and thoroughly clean them under running water making sure the jet openings are not clogged/blocked with food particles, Fig. 2.
2. Once thoroughly cleaned put the wash/rinse arms firmly back in place by tightening the fixing screws (C).

