

OPERATING INSTRUCTIONS RB-35

- Use only non-foaming, non-chlorinated detergents suitable for automatic dishwashers such as Rhima's range of detergents
- Ensure clear hose is inserted into the detergent bottle & green hose is inserted into rinse additive bottle
- For best performance connect machine to HOT water
- If pre-soaking do not use regular dishwashing liquid as significant foaming may result during the wash cycle

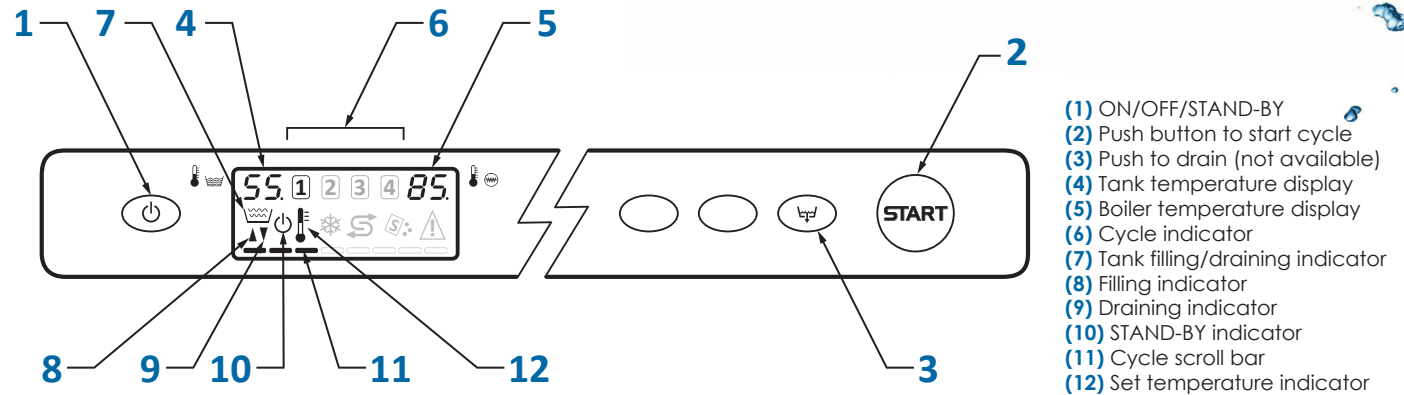

Operating the machine

INITIAL FILL AND HEATING

1. Close the door and press the ON/STAND-BY button (1)
2. Machine is ready for use when the TEMPERATURE REACHED INDICATOR (12) illuminates



FIG. 1

3. The WASH TANK (4) and BOILER (5) temperature indicators display the wash tank and boiler temperatures respectively

DISHWASHER OPERATION

1. Load the rack with cups/glasses ensuring they are inverted.
2. Close the door and start the wash cycle by pushing and holding the START button (2) for 1 second.
Note: The 4 wash programs (6) can be scrolled through by pressing & holding the START button (2). When the desired program is selected release the START button (2).
3. The wash cycle will begin, and the progress will be indicated on the CYCLE SCROLL BAR (11)
4. When cycle is finished the START button (2) will flash.
5. The washed items will air-dry within a few minutes of being removed from the dishwasher. The use of rinse additive will improve drying times.

Draining the machine

1. To maintain good wash results, the dishwasher should be drained and refilled every 2-4 hours depending on frequency of use and level of soil/residue on items being washed.

2. Press button (1) to put the machine in STAND-BY. Open the door and remove the OVERFLOW PIPE (A) Fig. 2 and the dishwasher will automatically empty the wash tank.

DO NOT REMOVE THE GREY PLASTIC FILTER (B) FIG. 2. THESE PREVENT SCRAPS OF FOOD GOING DOWN INTO THE DRAIN FILTER.

3. Once the tank has been emptied remove the PLASTIC FILTER (B) and wash all items under running water. Refit the PLASTIC FILTER (B) and the OVERFLOW PIPE (A) ready for the next use, Fig. 2.

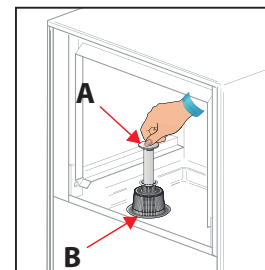

Fig.2

4. At the end of the day, the dishwasher should be drained, switched off and the door left open to ventilate.

Self Clean Cycle & Regular Maintenance

SELF CLEAN CYCLE

1. To run the SELF-CLEAN cycle, press and hold the START button (2) for 5 seconds and the SELF-CLEAN cycle will start automatically
2. On completion, drain the machine by following machine draining instructions

REGULAR MAINTENANCE

1. Remove the fixing screw (D) Fig. 3 to remove the wash/rinse arms (D). Check that the nozzles (E) Fig. 3 are not blocked with food waste. The nozzles can be removed for cleaning if required
2. Reinstall the wash/rinse arms using fixing screw (D) Fig. 3.

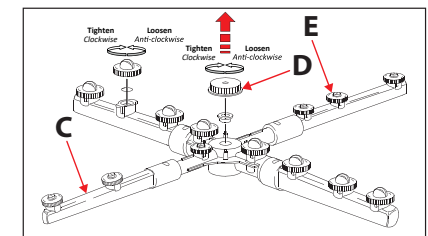

Fig.3